

After the Bluetooth RFID or Barcode reader or other input device has been setup, enable SerialMagic Gears to send scans to SerialMagic Keys.

From within SerialMagic Gears, press the Android Menu key (front button with horizontal bars), and choose Options.

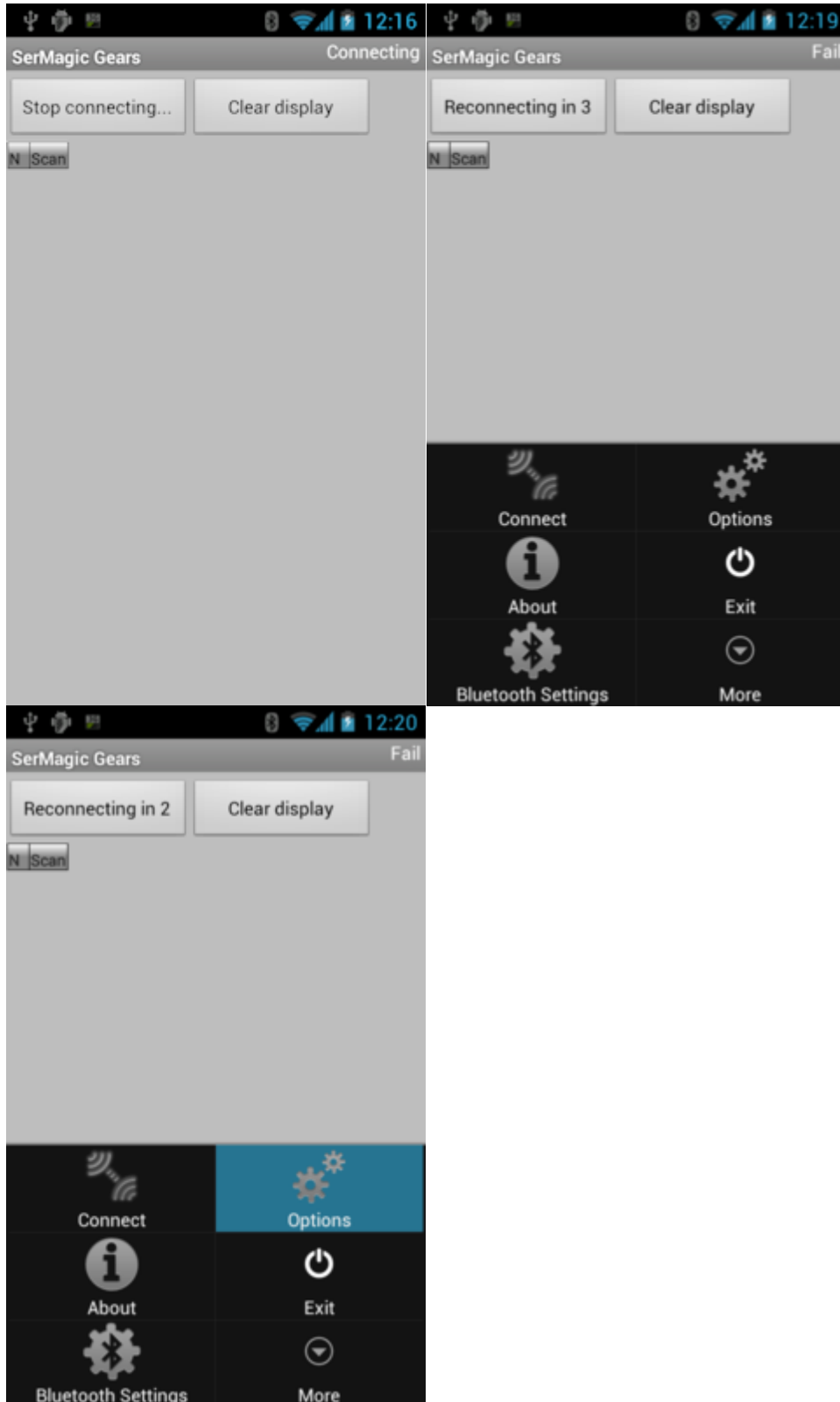

From within the SerialMagic Gears options, enable the option labeled **SerialMagic Keys** .

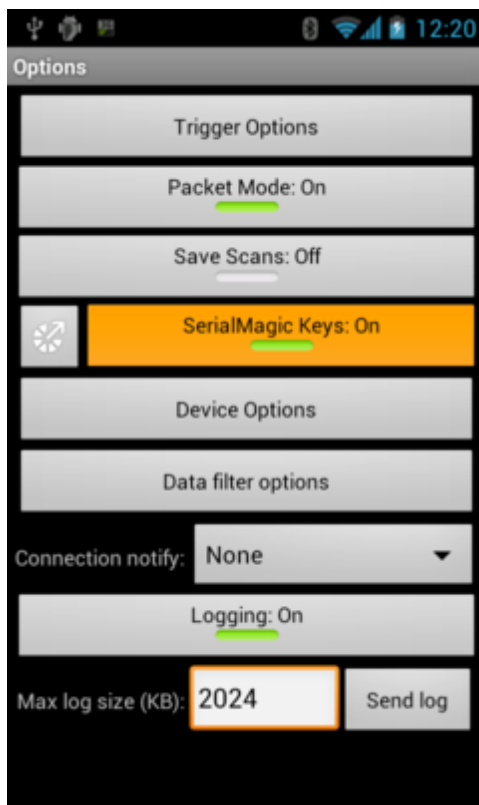

After enabling this option, open the **Settings** application on the Android device. Scroll down in the Settings to the **Language & input** options.



Within the Language & keyboard settings, enable the **SerialMagicKeys** keyboard by tapping on it. There will be a warning message, which is safe to accept, so tap OK.

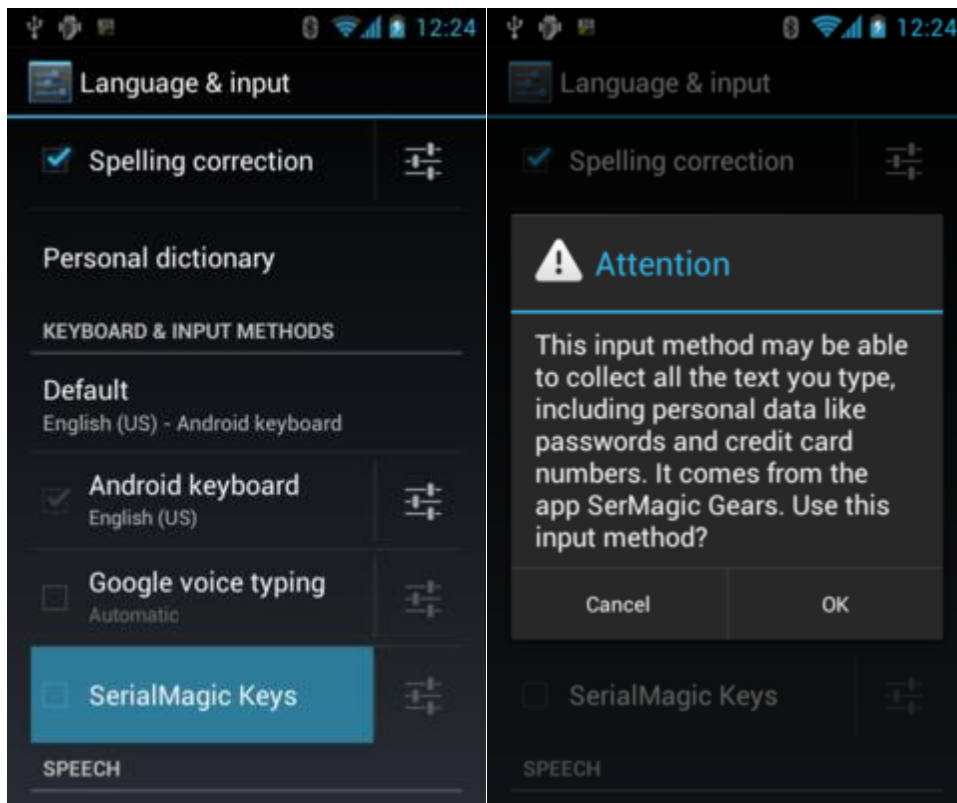

Now the SerialMagic Keys keyboard is enabled, tap "Default" and change the default keyboard to SerialMagic Keys.

Or, when the keyboard is shown, swipe down and select **Choose input method**, and then select **SerialMagic Keys**.

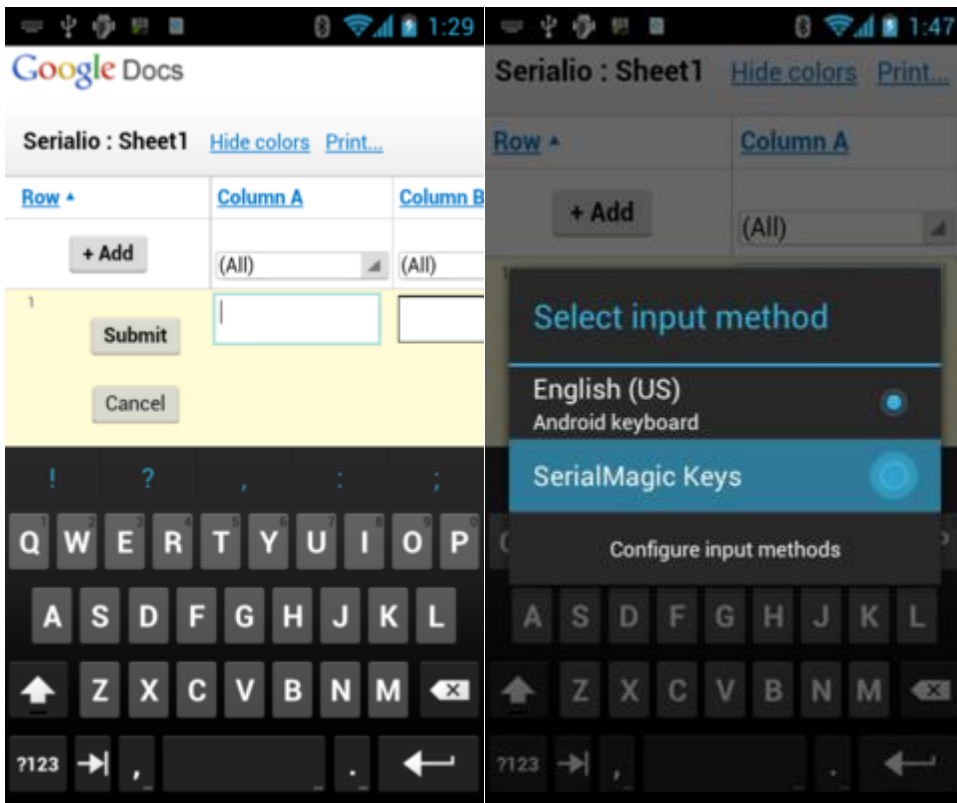

Now that the **SerialMagic Keys** keyboard is ready and active, you can begin scanning anywhere that you can type!

